

66 West End · Redruth · Cornwall · TR15 2SQ

t: 01209 210333

e: bill@billbannister.co.uk · www.billbannister.co.uk

# BILL BANNISTER

Sales & Lettings



## 52 Raymond Road

Redruth, TR15 2HF

**£259,950**



This well presented end of terrace house is situated in a popular area and benefits from well proportioned family accommodation. There are three bedrooms, two separate reception rooms, a kitchen, a rear porch/utility and a first floor bathroom with a second wc. The property is double glazed and this is complemented by gas fired heating. Externally there are enclosed gardens, a large single garage and the distinct bonus of parking facilities.





We are delighted to bring to market this characteristic end of terrace three bedroom property close to Redruth town centre with the benefit of both off-street parking and a large single garage. Built in 1910 and holding an elevated position above the town giving terrific views over towards the north coast of Cornwall, internally this three bedroom house features several high ceilings that certainly enhance the spacious living accommodation on offer. To the ground floor there are two reception rooms, used as a living room and a dining room by the current vendors. A galley style kitchen gives way to a rear porch that could be repurposed to a utility facility should the new owner so desire. To the first floor, two out of the three bedrooms are double whilst all three are complemented by a pleasant and spacious family bathroom with the added benefit of a further separate WC. Externally, a shared access lane from the street leads to the off street parking, with a gravel driveway complementing a large single garage with electric door opening and workshop come storage area. The rear garden also features a very nice, raised patio area that is positioned as such to fully benefit from the westerly views over towards the north coast of Cornwall. The property is very conveniently located, being around a half a mile walk or short drive into Redruth town centre which offers both independent and chain stores, cafes, a cinema and public houses. A main line railway station in the town gives links to London and bus services to Truro and Falmouth. Further afield, Portreath Beach on the north coast is within fifteen minutes drive as well as many other local beaches and attractions being nearby.

Upvc front door with two double obscure glazed panels and a high level double obscure glazed panel above leads to:

VESTIBULE

Internal front door with two frosted glazed panels, an obscure glazed side panel and an obscure glazed high level panel above leads to:

HALLWAY

Radiator and stairs to the first floor. Half wood panelling and a door leading to an understairs storage cupboard.

LOUNGE

11'7" x 14'2" (3.55m x 4.34m)

Upvc double glazed triple aspect bay window with westerly views towards St Ives. Storage cupboard converted to a window seat. Radiator and a multi fuel burner set in a tiled and wooden fireplace with a slate hearth.

DINING ROOM

10'0" x 12'11" (3.07m x 3.94m)

Radiator below a upvc double glazed window with far reaching north and westerly views overlooking the rear garden and aspect.

KITCHEN

9'6" x 11'6" (2.90m x 3.53m)

A galley style kitchen with a range of eye level and base level storage cupboards and drawers. Roll edge work surfaces and a ceramic single sink and drainer below a upvc double glazed window with deep tiled sill and far reaching westerly views towards the north coast. Space and plumbing for a washing machine and dishwasher. Space for a tumble dryer, space for a gas cooker and a tall fridge/freezer. Radiator and a door with two frosted glazed panels leading to:

REAR PORCH AREA

9'7" x 4'4" (2.93m x 1.33m)

Range of base level storage cupboards with roll edge work surfaces. Dual aspect double glazed windows with far reaching views towards the north coast overlooking the rear garden and aspect. A door opens to a storage cupboard housing a British Gas boiler and carbon monoxide alarm. Upvc double glazed door to the rear garden.

FIRST FLOOR

SPLIT LEVEL LANDING

Steps up to:

SECONDARY LANDING

BEDROOM 1

10'4" x 11'3" (3.17m x 3.44m)

With a built-in mini sink and a upvc double glazed window with far reaching views towards the north coast with a radiator below.

BEDROOM 2

9'1" x 12'10" (2.77m x 3.93m)

Upvc double glazed window overlooking the front aspect with a radiator below.

BEDROOM 3

6'4" x 9'4" (1.95m x 2.86m)

Upvc double glazed window overlooking the front aspect. Loft access hatch.

Steps up to:

SEPARATE WC

Low level wc and a wash hand basin with a tiled splash back. Storage cupboard with slatted shelving.

FAMILY BATHROOM

10'4" x 6'8" (3.15m x 2.05m)

Low level wc and a wash hand basin with a tiled splash back. Partial tiling throughout. Bath with a thermostatic rain shower over and a handheld shower mixer tap with a glass shower screen. Upvc double obscure window to the side aspect with a radiator below.

OUTSIDE

To the front a gate and steps lead up to the front door under a canopy. There is a raised pathway wrapping around the front window with a border of mature plants. A door from the rear porch leads down to the side access gate leading to a side access lane. There is a patio area with a wood store, an external tap, an outside light and a shed. There is a further raised patio with excellent far reaching westerly views towards the coast with block borders of plants. A small laid to lawn area is divided by a pathway which leads to a gravel driveway. This gives access to a LARGE SINGLE GARAGE with lighting, power, additional storage and a upvc double glazed window to the side aspect.

DIRECTIONS

From our office in Redruth proceed along Penryn Street and under the viaduct into Falmouth Road. Take the first turning left into Treurffe Hill and at the junction go straight over into Heanton Terrace. Go straight over again at the next junction into Raymond Road and the property will be found in the upper part on the left hand side.

AGENTS NOTE

TENURE: Freehold

COUNCIL TAX BAND: B.

SERVICES

Mains drainage, mains water, mains electricity and mains gas heating.

Broadband highest available download speeds - Standard 16 Mbps, Ultrafast 1800 Mbps (sourced from Ofcom).

Mobile signal -

EE - Good outdoor only, Three - Variable outdoor only, O2 - Good outdoor only, Vodafone - Good outdoor & indoor (sourced from Ofcom).

Area Map



Floor Plans

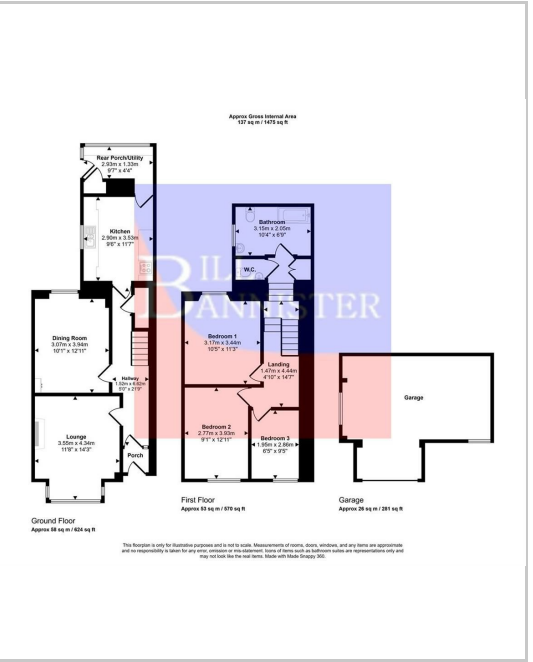

Energy Efficiency Graph

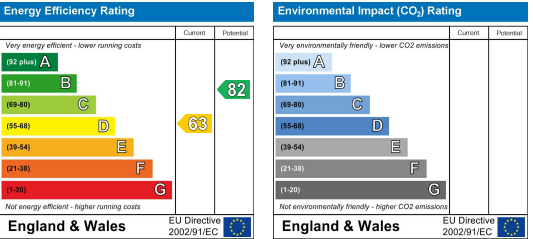

These particulars, whilst believed to be accurate are set out as a general outline only for guidance and do not constitute any part of an offer or contract. Intending purchasers should not rely on them as statements of representation of fact, but must satisfy themselves by inspection or otherwise as to their accuracy. No person in this firms employment has the authority to make or give any representation or warranty in respect of the property.